

ORIGINAL EQUIPMENT
WATER CONTROL

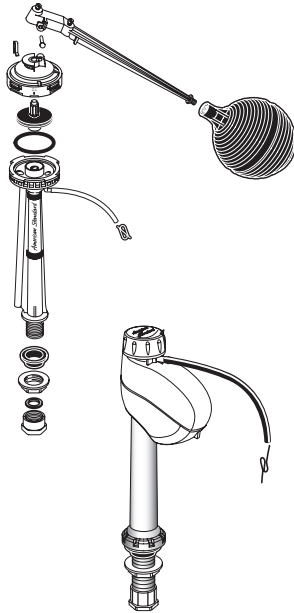

**REPLACEMENT
SMART VALVE
3198.000-B**

TANK
COVER



ORIGINAL
EQUIPMENT
TRIP
LEVER

BOLT
CAPS

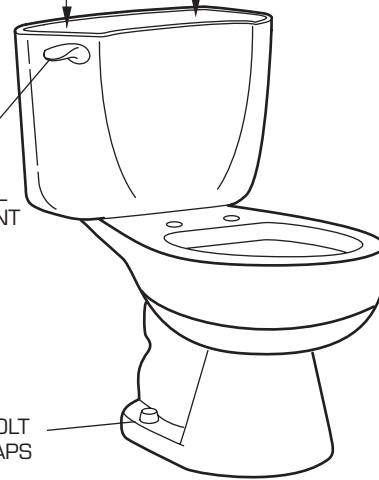

ORIGINAL EQUIPMENT
FLUSH VALVE



ORIGINAL
EQUIPMENT
FLAPPER
ASSEMBLY



REPLACEMENT BRASS ARM TRIP LEVER

LEFT HAND ONLY 8098.002 CHROME
AVAILABLE IN THE 8098.020 WHITE
FOLLOWING COLORS: 8098.099 POLISHED BRASS

★ Replace XXX with Fixture Color Code, YYY with Trim Finish

DESCRIPTION	▷ COMPONENT	PKG QTY
Round Front Bowl only w/(2) Bolt Caps	3112.030.020	1
Elongated Bowl only w/(2) Bolt Caps	3412.042.020	1
Tank w/Fittings & Cover	4029.016.020	1
Tank w/Fittings & Cover (UNED)	4029.500.020	1
Tank w/Fittings & Cover (TCLD)	4029.600.020	1
Tank w/Fittings & Cover (Lined w/TCLD)	4029.700.020	1
Tank Cover only	735018-400.020	1
ORIGINAL EQUIPMENT REPAIR PARTS	PART NUMBER	PKG QTY
Water Control Assembly (with Float Ball)	738145-0070A	1
Flush Valve	047387-0070A	1
Trip Lever	047242-0200A	1
Bolt Cap Kit	034783-0200A	1
Coupling Kit, Bowl-to-Tank	047188-0070A	1
Flapper Assembly	047146-0070A	1

▷ FOR COMPONENT PART ORDERING SEE CURRENT PRODUCT SELECTOR AND PRICING GUIDE.