

COLONY 1.6 G.P.F. TOILET MODEL NUMBER

American Standard

**2388 SERIES ROUND FRONT
2399 SERIES ELONGATED FRONT
2359 SERIES ELONGATED ADA**

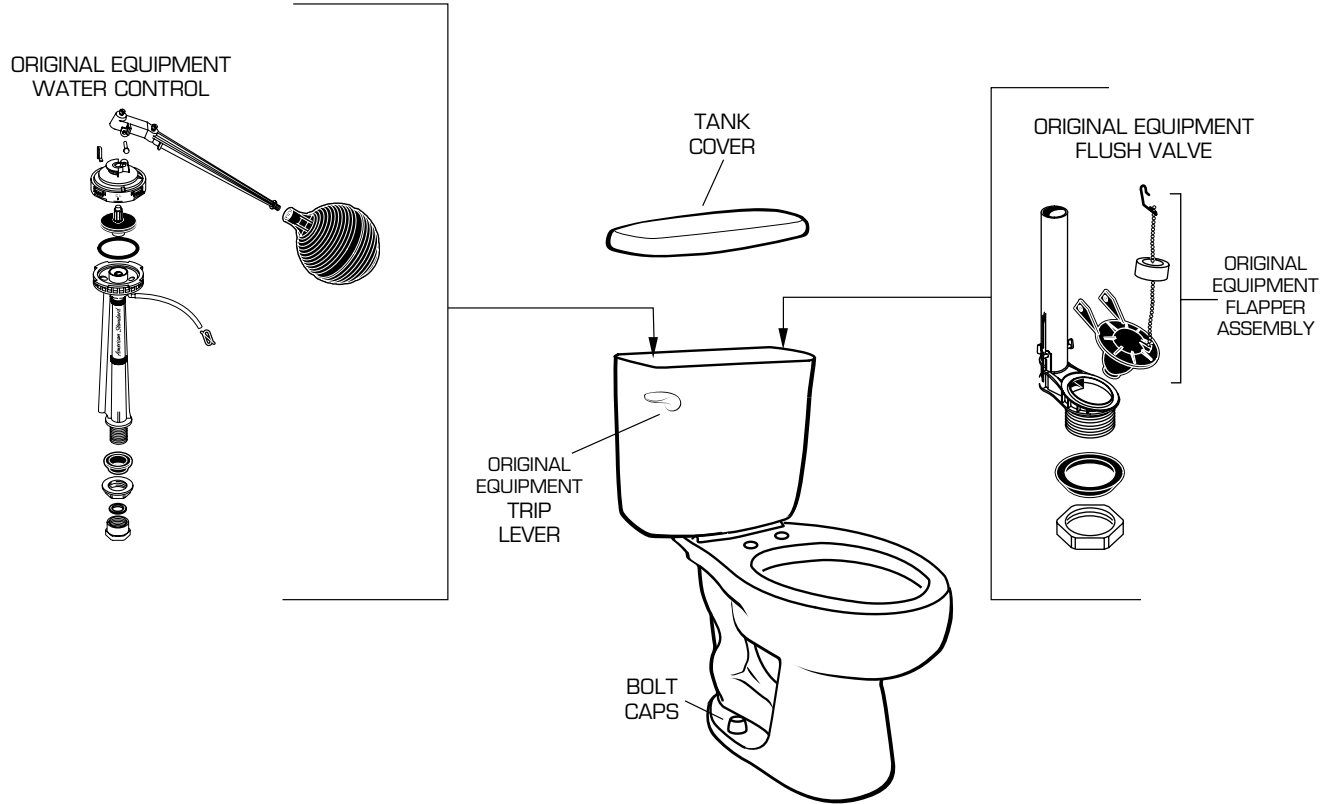

REPLACEMENT BRASS ARM TRIP LEVER
LEFT HAND ONLY 8098.002 CHROME
AVAILABLE IN THE 8098.020 WHITE
FOLLOWING COLORS: 8098.099 POLISHED BRASS

★ Replace XXX with Fixture Color Code, YYY with Trim Finish

| DESCRIPTION | ▷ COMPONENT | PKG QTY |
|--|--------------------|----------------|
| ★ Round Front Bowl only w/(2) Bolt Caps | 3338.012.XXX | 1 |
| ★ Elongated Bowl only w/(2) Bolt Caps | 3344.012.XXX | 1 |
| ★ Tank w/Fittings & Cover (12" R.L.) | 4392.016.XXX | 1 |
| ★ Tank w/Fittings & Cover (14" R.L.) | 4314.016.XXX | 1 |
| ★ Tank w/Fittings & Cover (10" R.L.) | 4310.016.XXX | 1 |
| ★ Tank Cover only (for 4392.016 Tank) | 735076-400-XXX | 1 |
| ★ Tank Cover only (for 4314.016 Tank) | 735078-400-XXX | 1 |
| ★ Tank Cover only (for 4310.016 Tank) | 735077-400-XXX | 1 |
| ORIGINAL EQUIPMENT REPAIR PARTS | PART NUMBER | PKG QTY |
| Water Control Assembly (with Float Ball) | 738372-0070A | 1 |
| Flush Valve | 738461-0070A | 1 |
| ★ Trip Lever | 047192-XXX0A | 1 |
| ★ Bolt Cap Kit | 034783-XXX0A | 2 |
| Coupling Kit, Bowl-to-Tank | 047158-0070A | 1 |
| Flapper Assembly | 738392-0070A | 1 |

▷ FOR COMPONENT PART ORDERING SEE CURRENT PRODUCT SELECTOR AND PRICING GUIDE.