

Ultima™ Selectronic® Battery Powered Toilet Flush Valve, Piston-Type

Long Life Power Pack (6066 Series)

- M964949-0021100A
COVER ASSEMBLY (1.1 gpf)
- M964949-0021280A
COVER ASSEMBLY (1.28 gpf)
- M964949-0021600A
COVER ASSEMBLY (1.6 gpf)
- M964949-0024000A
COVER ASSEMBLY (1.6/1.1 gpf)
- M964949-0023000A
COVER ASSEMBLY (1.28/1.1 gpf)

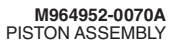
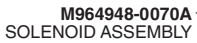
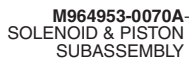
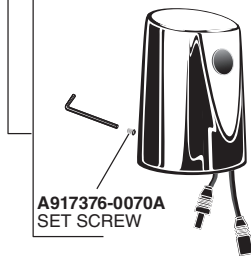

MODEL NUMBERS

- 6066.111
- 6066.121
- 6066.161
- 6066.721
- 6066.761
- 6066.521
- 6066.525
- 6066.561
- 6066.565

Power Source

Long Life Power Pack 6066 Series

M950361-0070A
LONG LIFE
POWER PACK

M950319-0071100A
SENSOR ASSEMBLY (1.1 gpf)

M950319-0071280A
SENSOR ASSEMBLY (1.28 gpf)

M950319-0071600A
SENSOR ASSEMBLY (1.6 gpf)

M950319-0075000A
SENSOR ASSEMBLY
(1.28/1.1 gpf)

M950319-0074000A
SENSOR ASSEMBLY
(1.6/1.1 gpf)

M950354-0020A
MANUAL VALVE

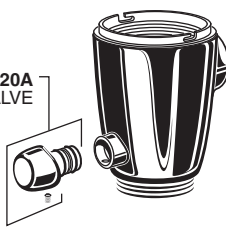

A912809-0070A
O-RING



M964945-0020A
ADJUSTABLE TAILPIECE
(4-1/4" to 5-1/4" Rough-in)

OPTIONAL ADJUSTABLE TAILPIECE
(Purchased Separately)

M962836-0020A (8-1/4" to 9-1/4" Rough-in)

M962835-0020A (7-1/4" to 8-1/4" Rough-in)

M962834-0020A (6-1/4" to 7-1/4" Rough-in)

M962833-0020A (5-1/4" to 6-1/4" Rough-in)

M964402-0070A
VACUUM BREAKER KIT



M964411-0020A
1-1/2" VACUUM BREAKER



A955057-0020A
1" INLET PIPE ASSEMBLY

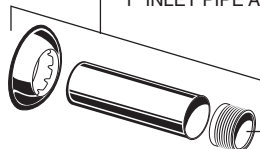

M962926-0070A
1" SWEAT ADAPTER

A955056-0020A
1" STOP VALVE KIT

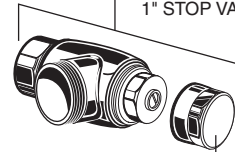

M924347-0020A
STOP VALVE CAP

M952269-0020A
ESCUTCHEON KIT



PART OF LIXIL



HOT LINE FOR HELP
For toll-free information and answers to your questions, call:

(844) CRT-TEAM / (844) 278-8326

Mon. - Fri. 8:00 a.m. to 8:00 p.m. EST Saturday 10:00 a.m. to 4:00 p.m. EST
IN MEXICO 01-800-839-1200

IN CANADA 1-800-387-0369 (TORONTO 1-905-306-1093)
Weekdays 8:00 a.m. to 7:00 p.m. EST

Product names listed herein are trademarks of AS America, Inc. ©2019

To learn more about American Standard Selectronic® Products visit our website at:
www.americanstandard-us.com or e-mail us at: CRTEAM@americanstandard.com